

# HERCULUX™

## H99 SERIES – DEEP PROFILE HOUSING

### PRODUCT FEATURES:

- » Surface mount – ceiling; 13"W×13"L×7"D
- » One-piece heavy duty die-cast housing
- » UV-stabilized, injection molded polycarbonate lens
- » Stainless steel Torx® fasteners



### PROJECT INFORMATION

Job Name \_\_\_\_\_

Fixture Type \_\_\_\_\_

Catalog Number \_\_\_\_\_

Approved by \_\_\_\_\_

### SPECIFICATIONS

**HOUSING:** One-piece heavy duty die-cast, low-copper aluminum housing. Housing flange interlocks around lens producing maximum moisture deflection and resistance to prying. Housing provided with four standoff mounting holes. One 3/4" IPS tapped hole on back of housing. Two 3/4" IPS tapped and plugged holes on sides of housing – see Cross Section/Details. Standard housing in dark bronze TGIC polyester powder coat – 5-stage pre-treatment.

**REFLECTOR:** High reflectance painted aluminum.

**LENS:** One-piece wraparound lens (UV-stabilized, high impact, virgin injection molded polycarbonate). Smooth exterior, prismatic interior. Nominal thickness: 0.125".

**VISOR:** One-piece injection molded opaque dark bronze polycarbonate (UV-stabilized). Optional finishes to match housing. Nominal thickness .125". Visor allows for full-cutoff light output.

**GASKET:** Die-cut closed cell neoprene gasket seals die-cast housing to ceiling surface. Lens inset into housing and sealed to integral ledge with one "O" ring closed cell silicone gasket.

**HARDWARE:** Four captive stainless steel Torx® T-20 with center pin fasteners secure lens/visor to housing.

**ELECTRICAL:** Available in 3500K, 4000K, and 5000K color temperatures, 80 CRI. 120-277VAC or 347VAC, 50/60Hz electrical input with high power factor electronic, constant-current driver (>.90 PF). Standard 0-10V dimming with 1-100% range; maximum driver source of 200 µA.

**SENSOR & CONTROLS:** Optional sensor available with compatible third party controls. To see the full list of compatible controls, [click here](#).

**INSTALLATION:** Standard four-point mounting required for Peace of Mind Guarantee®.

**PHOTOMETRICS:** Photometry tested to the IESNA LM-79-08 standard by an ILAC/ISO17025 accredited laboratory. For additional photometric data, please go to [www.kenall.com](http://www.kenall.com).

**WARRANTY:** Limited five (5) year LED warranty. [Peace of Mind Guarantee against breakage](#).

**LISTINGS:** Luminaire is certified to UL Standards by Intertek Testing Laboratory for Wet Location.



### ORDERING INFORMATION (Ex: H99DSD-PP-MB-25L40K-DV)

Model	Lens Type	Finish	Lamp Type	Voltage	Options	Accessories
<b>H99DSD</b>	<b>PP</b>					
	<b>Lens Type</b>		<b>Lamp Type</b>		<b>Options</b>	
	PP Pearlescent Polycarbonate		<b>15L35K</b> 15 Watt 3500K LED		<b>BPC*</b> Photo Control – Button Type (120 or 277V only)	
			<b>15L40K</b> 15 Watt 4000K LED		<b>LEL†</b> LED Emergency Battery Backup (n/a with 347V)	
	<b>Finish</b>		<b>15L50K</b> 15 Watt 5000K LED		<b>20KV†</b> 20KV/KA Surge Protection per IEEE/ANSI C62.41.2 Cat. A	
	DB Dark Bronze		<b>25L35K</b> 25 Watt 3500K LED		<b>FS</b> Single Fuse & Holder	
	FG Forest Green		<b>25L40K</b> 25 Watt 4000K LED		<b>QMS*†</b> Quick Mount System (n/a with 347V) – Damp Location Only (Mounting base ordered separately – see Accessories)	
	LG Light Gray		<b>25L50K</b> 25 Watt 5000K LED			
	MB Matte Black				<b>Accessories</b>	
	MW Matte White		<b>Voltage</b>		<b>9100C</b> Quick Mount System Mounting Base – for use with	
	SL Silver		<b>120</b> 120 Volts		QMS option fixtures (n/a with 347V)	
	CC Custom Color (Consult factory)		<b>277</b> 277 Volts			
			<b>347▼</b> 347 Volts			
			<b>DV▼</b> 120-277 Volts			

† LEL not available in conjunction with QMS or 20KV

▼ n/a with BPC

\* n/a with 347 or DV Voltage type



[www.kenall.com](http://www.kenall.com) | P: 800-4-Kenall | F: 262-891-9701 | 10200 55th Street Kenosha, Wisconsin 53144, USA

A brand of **legrand**

This product complies with the Buy American Act: manufactured in the United States with more than 50% of the component cost of US origin. It may be covered by patents found at [www.kenall.com/patents](http://www.kenall.com/patents). Content of specification sheets is subject to change; please consult [www.kenall.com](http://www.kenall.com) for current product details. ©2022 Kenall Mfg. Co.

# HERCULUX™

## H99 SERIES – DEEP PROFILE HOUSING

### PERFORMANCE

Lamp Type	Initial Delivered Lumens		Input Power (W)	Drive Current (mA)	Estd. L70 LED Life (Hrs)
	@ 25°C	Efficacy (lm/W)			
15L35K	1774	90	20	54	100,000
15L40K	1774	90	20	54	100,000
15L50K	1934	98	20	54	100,000
25L35K	2601	88	30	90	100,000
25L40K	2601	88	30	90	100,000
25L50K	2835	96	30	90	100,000

Info subject to change. Visit [www.kenall.com](http://www.kenall.com) for IES files and additional information.

Model: H99DSD-PP-MW-25L40K-DV

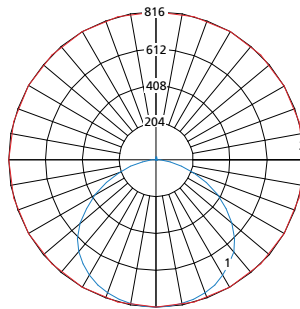

Max Candela = 816 Located At Horizontal Angle = 0, Vertical Angle = 0

- 1 - Vertical Plane Through Horizontal Angles (0-180) (Through Max. Cd.)
- 2 - Horizontal Cone Through Vertical Angle (0) (Through Max. Cd.)

### DIMENSIONAL DATA

#### CROSS SECTION / DETAILS

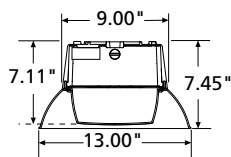

#### BACK MOUNTING VIEW

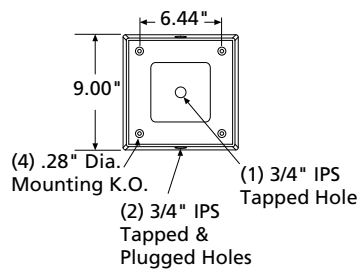

[www.kenall.com](http://www.kenall.com) | P: 800-4-Kenall | F: 262-891-9701 | 10200 55th Street Kenosha, Wisconsin 53144, USA

This product complies with the Buy American Act: manufactured in the United States with more than 50% of the component cost of US origin. It may be covered by patents found at [www.kenall.com/patents](http://www.kenall.com/patents). Content of specification sheets is subject to change; please consult [www.kenall.com](http://www.kenall.com) for current product details. ©2022 Kenall Mfg. Co.

A brand of **legrand**