

# MILLENNIUM STRETCH™

## MLR55 SERIES – CONTINUOUS ROW

### PRODUCT FEATURES:

- » Surface mount – ceiling or wall; 5" x 48"
- » Extruded aluminum housing with decorative end caps
- » Low-profile –ADA compliant

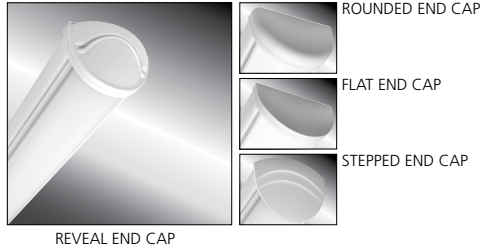

PROJECT INFORMATION	
Job Name	_____
Fixture Type	_____
Catalog Number	_____
Approved by	_____

### SPECIFICATIONS

**HOUSING:** Marine grade aluminum. Extruded body with die-cast end caps. Housing, with end caps, post assembly TGIC polyester powder coat finished – 5-step pre-treatment. See Ordering Information for standard, optional, architectural and custom finishes. Each linear run of luminaires consists of one Beginning of Run Luminaire (B), one or multiple Middle Luminaire(s) (M), and one End of Run Luminaire (E). Specify and/or order systems per linear run (i.e. (1)B48, (5)M48, (1)E48). NOTE: Contact factory for custom lengths.

**REFLECTOR:** Full reflector/wire cover – 92% reflectivity.

**LENS:** UV-stabilized, high impact extruded pearlescent polycarbonate. Smooth exterior, linear prismatic interior. Nominal thickness .156". Lens securely positioned in body channels and end caps. Lens locked in place with tamper-resistant stainless steel Torx® T-20 with center pin fasteners and sealed with closed cell gaskets.

**END CAPS/JOINER BANDS:** Marine grade die-cast aluminum. Four end cap styles available: Flat, Rounded, Reveal and Stepped. Conduit/Wiremold™ knockout visible only from interior of end cap (Flat and Rounded styles only).

**HARDWARE:** Four stainless steel, tamper-resistant Torx® T-20 with center pin fasteners secure lens in housing body's lens channel.

**ELECTRICAL:** Available 3500K, 4000K and 5000K color temperatures, 82 CRI. 120-277VAC, 50/60Hz electrical input with serviceable high power factor electronic, constant-current driver (<20% THD, >0.95 PF). Standard 0-10V dimming with 3-100% range, maximum driver source of 250 µA. Consult factory for fluorescent option.

**SENSOR & CONTROLS:** Optional sensor available with compatible third party controls. To see the full list of compatible controls, [click here](#).

**INSTALLATION:** Standard four-point mounting per fixture recommended.

**WARRANTY:** limited ten (10) year LED warranty.

**LISTINGS:** Damp Location Listed to UL 1598 – corner, horizontal wall, vertical wall and pendant mount installation. See Options for Wet Location – covered ceiling mount. ADA compliant.



### ORDERING INFORMATION (Ex: MLR55S-B48-2/M48-E48-R-MW-PP-45L40K-DCC-DV-FS)

Model	Begin. Hsg.	Mid. Hsg.	End. Hsg.	End Cap	Finish	Lens	Lamp Type	Driver	Voltage	Options
<b>MLR55S</b>	<b>B48</b>	<b>/M48</b>	<b>E48</b>			<b>PP</b>				
<b>Beginning of Run Housing Style</b>				<b>Lens</b>		<b>Options</b>				
<b>B48</b> Nominal 48" housing				<b>PP</b> Pearlescent Polycarbonate		<b>CDF</b> Captive Diffuser Fasteners				
<b>Middle Fixture(s) Housing Style</b>				<b>Lamp Type</b>		<b>FS</b> Single Fuse & Holder				
<b>(replace "x" with qty)</b>				<b>45L35K</b> 45 Watt 3500K LED		<b>PH</b> Phillips Head Fasteners				
<b>(x)/M48</b> Nominal 48" housing(s)				<b>45L40K</b> 45 Watt 4000K LED		<b>PM§</b> Pendant Mount (Max. 3/8NPT stems by others; damp only)				
<b>Ending of Run Housing Style</b>				<b>45L50K</b> 45 Watt 5000K LED		<b>WL</b> Wet Location Rating (covered ceiling only)				
<b>E48</b> Nominal 48" housing				<b>Driver Type</b>		<b>Accessories</b>				
<b>End Caps</b>				<b>DCC</b> Dimming Constant Current		<b>CMB§</b> Corner Mount Bracket (Must be ordered with DL Option)				
<b>R</b> Rounded				<b>Voltage</b>		§ PM and CMB not available in conjunction				
<b>F</b> Flat				<b>120</b> 120 Volts						
<b>RV</b> Reveal				<b>277</b> 277 Volts						
<b>SP</b> Stepped				<b>347</b> 347 Volts (Consult Factory)						
<b>Finish</b>				<b>DV</b> 120-277 Volts						
<b>MW</b> Matte White										
<b>MB</b> Matte Black										
<b>LG</b> Light Gray										
<b>CC</b> Custom Color (Consult Factory)										



www.kenall.com | P: 800-4-Kenall | F: 262-891-9701 | 10200 55th Street Kenosha, Wisconsin 53144, USA

A brand of **legrand**

This product complies with the Buy American Act: manufactured in the United States with more than 50% of the component cost of US origin. It may be covered by patents found at [www.kenall.com/patents](http://www.kenall.com/patents). Content of specification sheets is subject to change; please consult [www.kenall.com](http://www.kenall.com) for current product details. ©2022 Kenall Mfg. Co.

# MILLENIUM STRETCH™

## MLRS5 SERIES – CONTINUOUS ROW

### PERFORMANCE

Lamp Type	Initial Delivered Lumens		Input Power (W)	Drive Current (mA)	Estd. L70 LED Life (Hrs)
	@ 25°C	Efficacy (lm/W)			
45L35K	4246	85	50	94	150,000
45L40K	4526	90	50	94	150,000
45L50K	4707	94	50	94	150,000

Displayed information is for selected luminaires only. Additional wattages and color temperatures are also available. Visit [www.kenall.com](http://www.kenall.com) for additional information.

Model: MLRS5-48-F-MW-PP-1-45L40K-DCC-1-DV

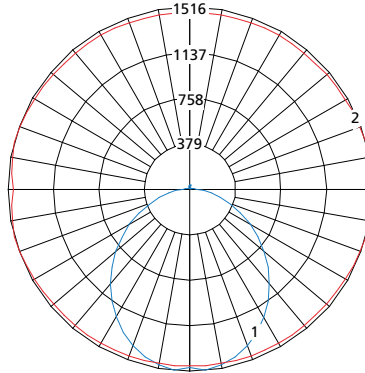

Maximum Candela = 1241 Located At Horizontal Angle = 15, Vertical Angle = 5

- 1 - Vertical Plane Through Horizontal Angles (15-195) (Through Max. Cd.)
- 2 - Horizontal Cone Through Vertical Angle (5) (Through Max. Cd.)

### DIMENSIONAL DATA

#### CROSS SECTION/DETAILS

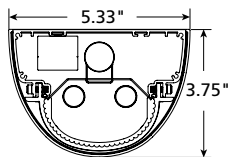

#### CORNER MOUNT BRACKET

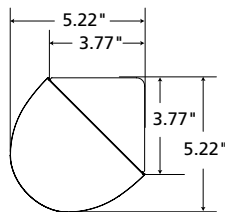

#### Nominal Four Foot Fixture Legend

End Cap	A	B	C	D	E1	E2	F
R	49.93	49.34	49.93	46.25	3.00	6.00	44.48
F	49.32	49.34	49.32	46.25	3.00	6.00	44.48
SP	50.73	49.34	50.73	46.25	3.00	6.00	44.48
RV	50.50	49.34	50.50	46.25	3.00	6.00	44.48

#### MOUNTING HOLES

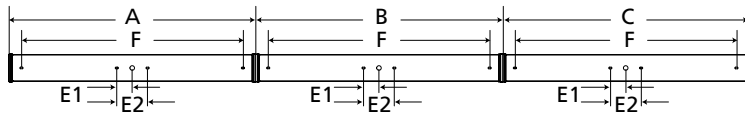

#### PM OPTION ONLY

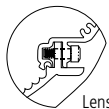
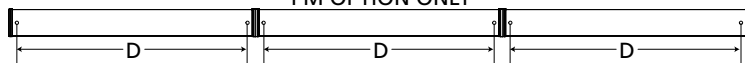

Lens Lockup Detail

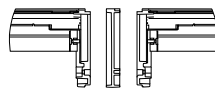

Joiner Band  
(Required for row mounting - supplied)



[www.kenall.com](http://www.kenall.com) | P: 800-4-Kenall | F: 262-891-9701 | 10200 55th Street Kenosha, Wisconsin 53144, USA

A brand of Legrand

This product complies with the Buy American Act: manufactured in the United States with more than 50% of the component cost of US origin. It may be covered by patents found at [www.kenall.com/patents](http://www.kenall.com/patents). Content of specification sheets is subject to change; please consult [www.kenall.com](http://www.kenall.com) for current product details. ©2022 Kenall Mfg. Co.